



ENVI®

Next generation electric showers

Quick-Start User Guide

TRITON

For a cleaner conscience

2181684A

ENVi® Controller Layout

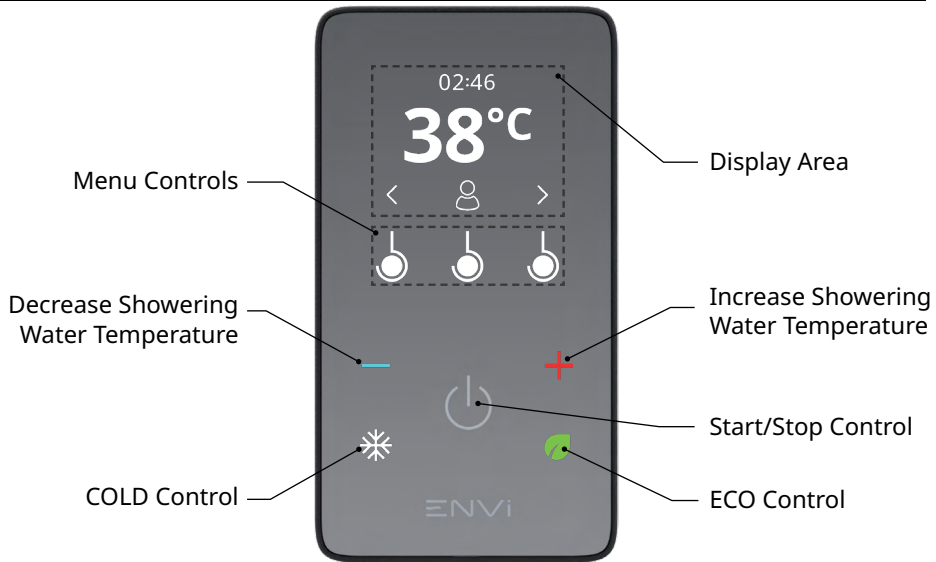

Switching the Shower On

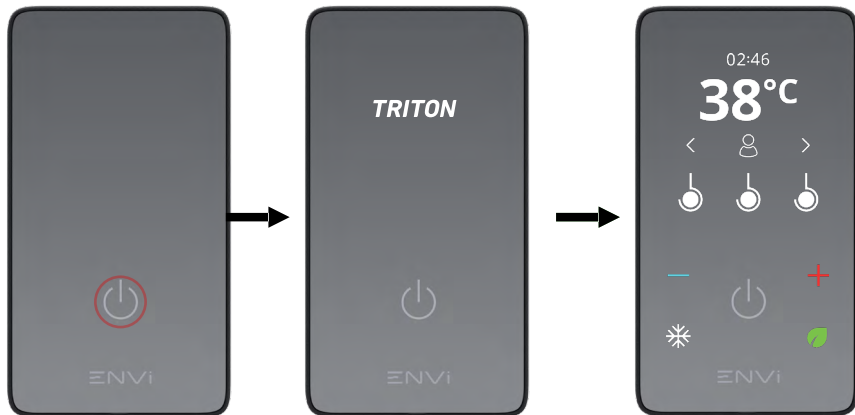

Once Commissioned, and upon connecting ENVi® to power, the Start/Stop icon  on the controller is illuminated, touch it to start showering. The shower temperature and timer will be set to their default values.

Showering Controls



Touch the — or + icons to change the shower temperature.
Touch the ❄ icon to run the shower at ambient water temperature.
Touch the 🍃 icon to decrease the shower timer by one minute.

ENVi® Mode and User Profiles

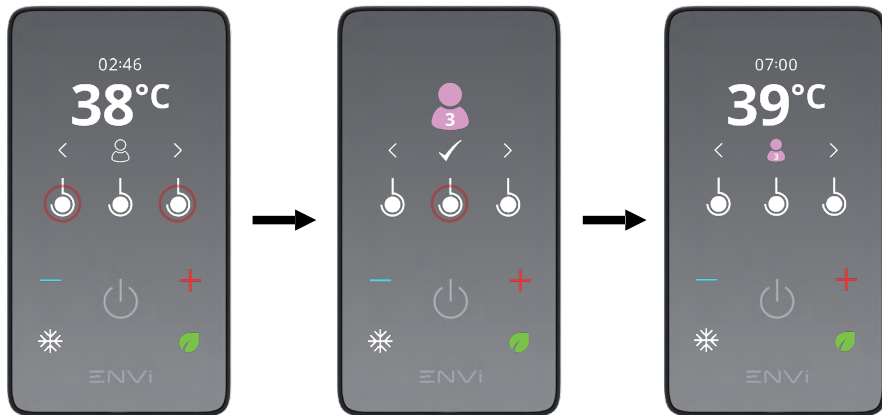

Touch the circular symbols under the left < and right > chevrons to browse and the circular symbol under the tick ✓ to select between six User Profiles. Upon selecting a User Profile, the shower will automatically adjust the shower temperature and timer to the personalised settings.



Switching the Shower Off

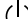

Once the timer has elapsed, or if the Start/Stop icon  is touched whilst showering, ENVi® will enter phased shut down, which protects the Tri-HUB by purging it of hot water before turning fully off.

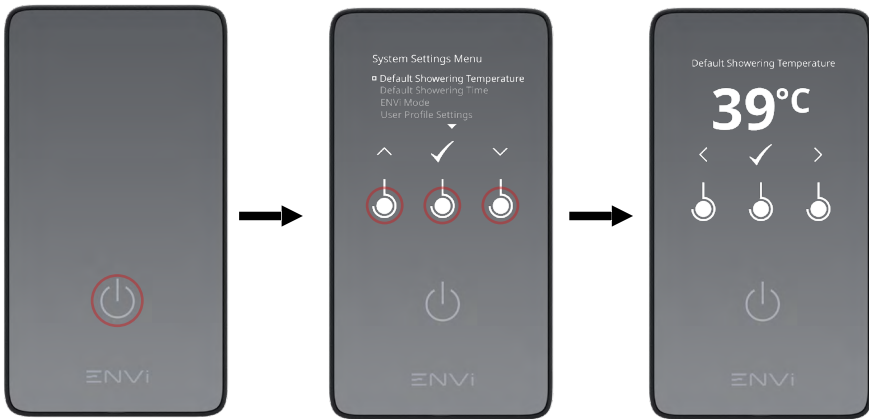
System Settings



Touch and hold the **Start/Stop** icon  for five seconds whilst ENVi® is in Standby to enter the System Settings. Touch the circular symbols under the **Up** ^ and **Down** v chevrons to browse System Settings Menu, and use the circular symbol under the tick ✓ to select the option. Press the **Start/Stop** icon  to return to Standby.

Scan for ENVi® Product Support Page

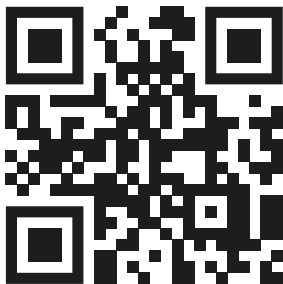

tritonshowers.co.uk/envisupport

Or call our Customer Experience team:
02476 372 222