

CENTINEL WALL HUNG URINAL

G20120N

Manufactured from 1.2mm thick grade austenitic stainless steel polished to a satin polish finish. Each urinal is supplied complete with 50mm waste, sparge pipes, interconnecting pipework, plastic cistern and downpipe. The waste outlet is positioned centrally in the length of the urinal. The urinals is supplied with exposed sparge pipes, the recommended height for fixing the cisterns is 750-950mm, from the underside of the cistern to the top return of the urinal. All urinals are screw fixed to the wall through fixing holes in the top flange together with separate wall mounted brackets which support the base of the unit.

Exposed Spargepipes

9 litre cistern and downpipe

CE Certified

ARTICLE NUMBER

G20120N

EAN 7612979003291

TECHNICAL DATA

| | |
|--------------------|--------------------------------|
| Material | stainless steel |
| Material code | 1.4301 Chrome Nickel steel V2A |
| Material thickness | 1.20 mm |
| Surface finish | satin finished |
| Gross weight | 16 kg |
| Net weight | 13 kg |
| Type of mounting | wall mounting |
| Overall width | 1200 mm |
| Overall height | 710 mm |
| Overall depth | 300 mm |
| Type of flushing | water flushed |
| Water inlet | exposed |
| Water outlet | exposed |

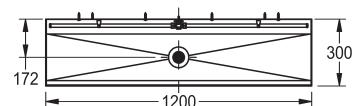
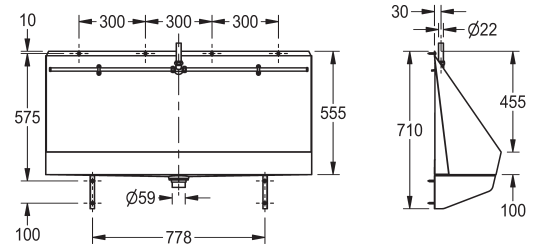

Franke Washroom Systems
 ws-info.uk@franke.com
 www.franke.com

2013-11-04, Franke WS